

SKYRAIL

RESIDENTIAL BUILDING

Skyrail

The one-way ribbed slab formed with SKYRAIL has many structural advantages, with increased dynamic and static performance of the structure thanks to the reduced self weight and the arc-formed ribbing.

The elimination of the filler material (ceramic, concrete, polystyrene or else) leaves a channel that can be used for the passage of tubes and systems.

The installation of a false ceiling makes the ribbed slab particularly suitable for residential use.

Advantages

- Reduction of the slab's self weight
- Better seismic behaviour
- Decreased load on the foundation
- Reduced size of beams and columns
- Creation of one-way ribbing with variable cross-section

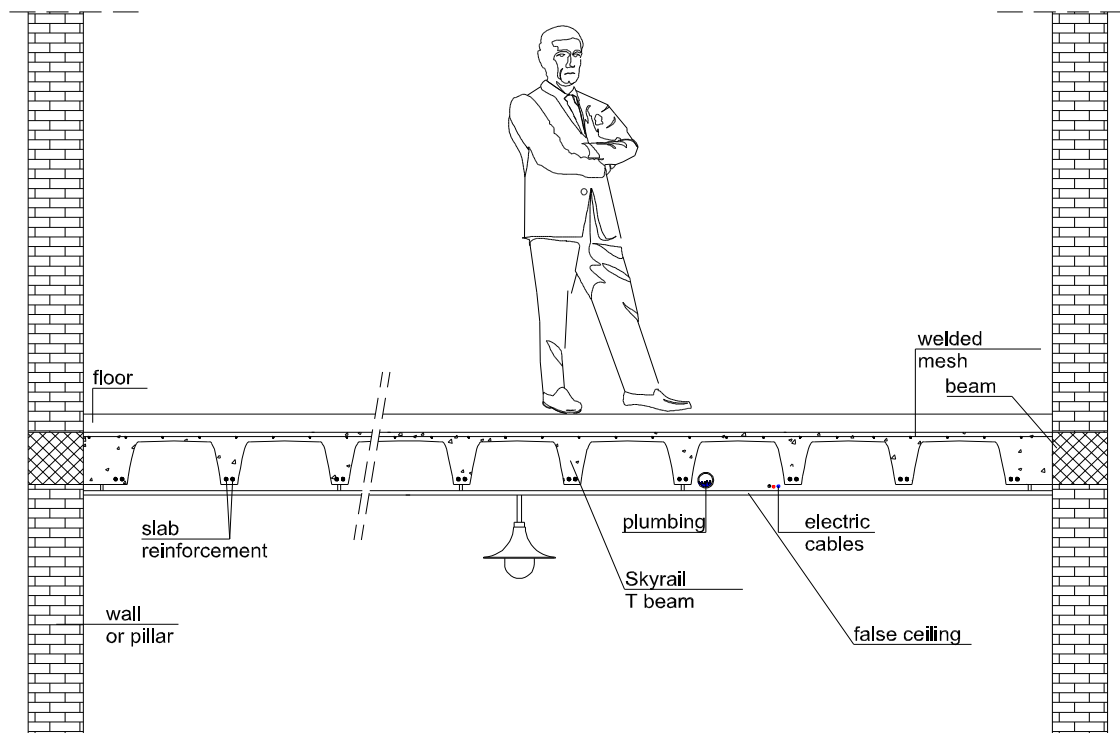

GENERAL TECHNICAL CHARACTERISTICS

Slab thickness		Loads (EC2)		Self weight	Max.
Rib	r.c. cover	Dead	Live	of slab	span
[in]	[in]	[lb/sqin]	[lb/sqin]	[lb/sqin]	[ft]
6.29	1.97	0.21	0.28	0.30	18.04*
7.87	1.97	0.21	0.28	0.34	20.67*
9.45	1.97	0.21	0.28	0.38	22.96*

*refers to a beams reinforced with 0.622 [sqin]

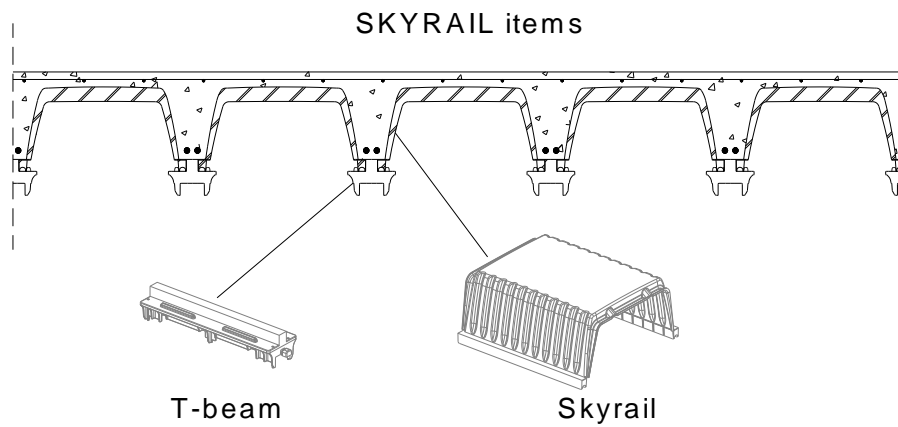

**Skyrail r.c. slab
cross-section**

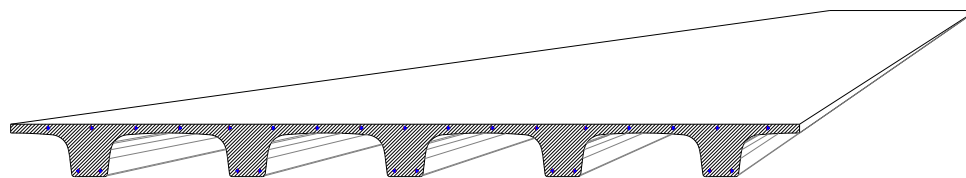

Cost advantages

- Elimination of filler materials
- Lower amount of steel
- Cost effective logistics and easy storage
- Initial investment amortised after few pours

Job-site advantages

- Fast and easy to erect
- Load-bearing before the pour
- Creates a passage for pipes and systems