

# MINIMODULO

## REFURBISHMENTS

### Minimodulo

Minimodulo is used to add a floor onto an existing slab without greatly increasing the slab thickness, reducing the concrete consumption and guaranteeing a high load-bearing capacity.

The voids make it possible to ventilate the floor, eliminating moisture and condensation.

### Advantages

- Natural ventilation
- Elimination of moisture and condensation
- Low weight
- Low heat transmission
- High load-bearing capacity

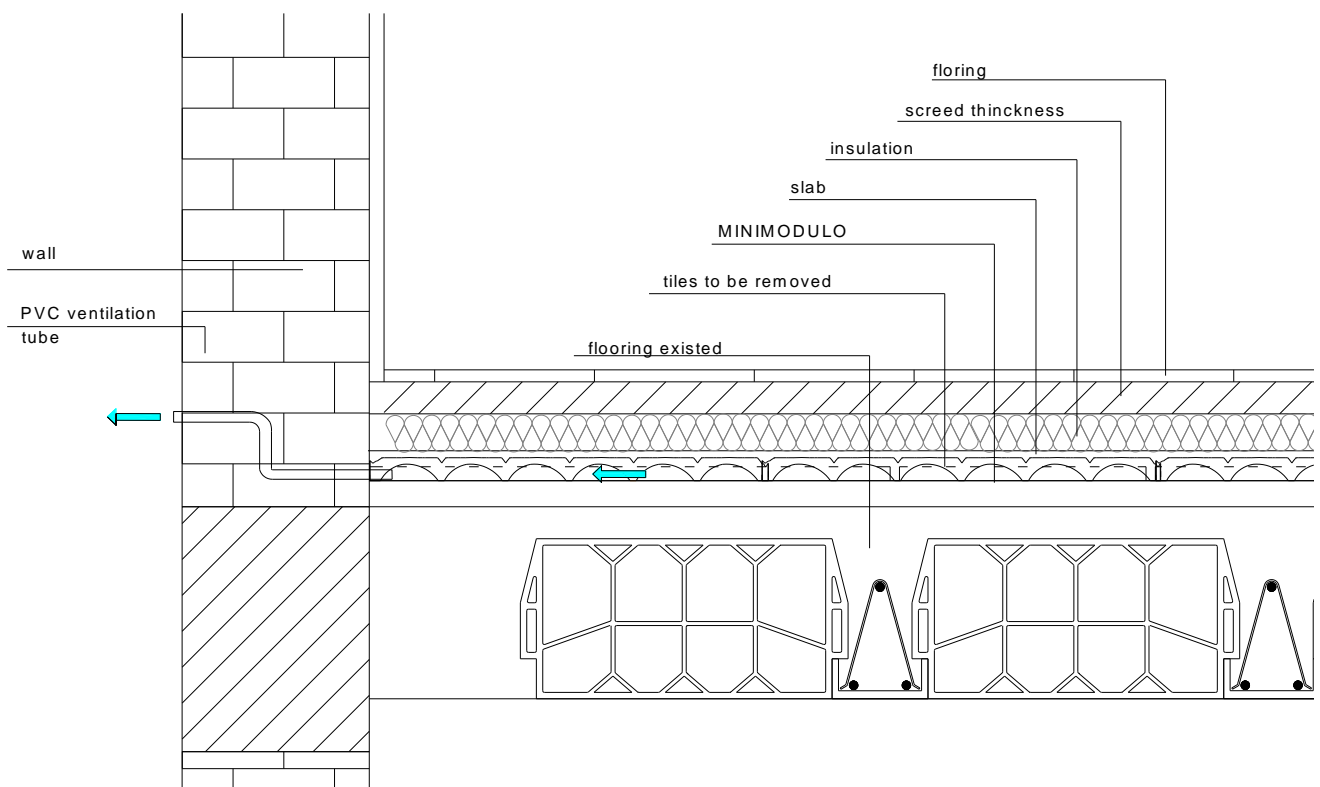

### Applications

New floor on existing slab

Garage renovation